



NORTHERN EUROPE

Automator DK ApS (Denmark)
Vestergade 47 • DK-7100 Vejle
Tel. 0045-70200263 • Fax 0045-70200264
www.automator.com • E-mail: dk@automator.com

Automator UK (Great Britain)
48 Station Road • HARROW • Middlesex • HA1 2SQ
Tel. 020 8863 7141 & 6399 • Fax 020 8861 3658
www.automator.com • E-mail: uk@automator.com

CENTRAL EUROPE

PMS Präge + Markier Systeme AG (Switzerland)
Schönenhofstrasse 17, CH-8502 Frauenfeld
Tel. +41-(0)527250270 • Fax +41-(0)527250277
www.automator.com • E-mail: pms@automator.com

WESTERN EUROPE

Iberomark Marcado Industrial, SL (Spain)
Carretera Nova 127 • E-08530 La Garriga (Barcelona)
Tel. +34-938717095 • Fax +34-938717531
www.automator.com • E-Mail: clientes@automator.com

EASTERN EUROPE

Automator CZ, AS (Czech Republic)
Chrastavice 3, CZ-344 01 Domallice
Tel. +42 0189 8289 - 0189 8290 • Fax +42 0189 8290
www.automator.com • E-mail: cz@automator.com

SOUTHERN EUROPE

Automator Hellas (Greece)
P.O.Box 50772 • 54014 Thessaloniki
Tel. / Fax +30 31 438378
www.automator.com • E-mail: gr@automator.com

NORTH AMERICA

Markfirst Inc. (U.S.A.)
5763 Mining Terrace • Jacksonville 32257 Florida
Tel. +1-904-2921355 • Fax +1-904-2924920
www.automator.com • E-mail: usa@automator.com

SOUTH AMERICA

Central de Equipos Automaticos S.a. (Venezuela)
Urb. Los Cedros • Apt. 50062 • Sabana Grande
Caracas • Venezuela
Tel. +58-2-7311371 • Fax +58-2-7311369
www.automator.com • E-mail: yv@automator.com

OCEANIA

Nichol International Pty Ltd (Australia)
Terracotta Drive 50 • 3131 Nunawading Vic.
Tel. +61-3-98947788 • Fax +61-3-98947977
www.automator.com • E-mail: aa@automator.com

FAR EAST

Toyo Corporation (Japan)
Nakayamacho 5 Chome 10 • 00448 Aichi-ken Kariya Shi
Tel. +81 566 232011 • Fax +81 566 272221-231080
www.automator.com • E-mail: jp@automator.com



AUTOMATOR INTERNATIONAL s.r.l.
Via Meucci, 8 • I-20094 Corsico (Milano) - Italy
Tel. +39-0248601445 r.a. • Fax +39-0248601503
www.automator.com • E-Mail: info@automator.com

Specifications are subject to change without notice - VERSION 01



ROLLER MARKING MACHINES



Standard Marking Systems Available Using Automator Technology

INDENT MARKING

Impact and roller marking guarantee clear, easily legible and permanent identification.

HOT MARKING

For materials such as leather, pelts, plastics, wood, paper, textiles etc; can also be used with interchangeable foils for marking in colour.

SAND JET MARKING

The pre-selected text is marked by a light abrasion of the top surface using micro-crystals. Particularly suitable for glass or metals which have already been heat treated.

COMPUTER CONTROLLED SINGLE DOT OR MULTI-DOT MARKING SYSTEMS

Linear, diagonal, arc or angular marking by indenting one or more styli into the surface of the part to be marked.

READING AND RECOGNITION

Identification by a camera and processing using specially written software.

MARKING OF NAMEPLATES

A large range of machines is available from manually operated models to highly sophisticated systems.

LASER MARKING

CO2 and YAG laser systems for marking of all types of material using the controlled movement of a focused laser beam.

ELECTROLYTIC MARKING

Suitable for marking hardened or shaped components. The marking unit imparts a controlled electrical impulse to the marking pad which leaves a permanent and indelible mark.

HYDRAULIC MARKING

Used for the portable marking of car bodies, profiles, tubes and beams.

DAISY WHEEL MARKING MACHINES

PC controlled marking units for marking silently and without deformation.

SPECIAL MACHINES

Designed and manufactured to meet specific requirements for marking, stamping and identification.

AUTOMATOR INTERNATIONAL presents its extensive range of standard and special machines for marking, stamping, identifying, punching, numbering, lettering etc. ... in other words for leaving an indelible and permanent mark on any surface or product whatever.

Impeccable quality and the highest technology are the basis for our ability to meet the most demanding and varied requirements of our customers, whatever branch of industry they

may come from.

The extensive range which constitutes the AUTOMATOR program provides the highest productivity using the latest

production processes.

More than 50 years' experience guarantees that Automator will offer their customers an exclusive service to solve their particular marking problems.

Starting with interchangeable types and hand stamps, through mechanical and



pneumatic machines, and finally reaching the latest, most advanced and innovative computerised

systems, Automator always takes a

leading role thanks to the very high qualitative and technological standards it sets for itself in the international market place.



Automator is also very well represented in emerging markets overseas and in the far east.

An extremely well trained and conscientious staff which is focused on progress and innovation to obtain the highest precision and quality for the product and for customer service is the corner-stone of Automator's success.

Reliability is for Automator the trademark which knows no frontiers.

AUTOMATOR - WHO ARE WE



SMALL DIAMETERS

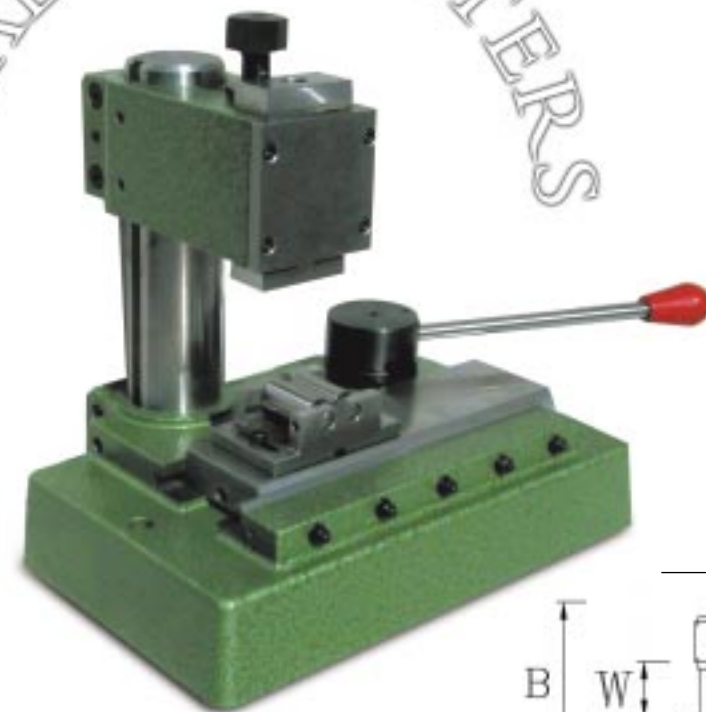

MODEL MB 41N

- The manual roller marking machine for the perfect marking of round components, either solid or hollow from 8-65mm diameter.
- Solid round components are marked using roller support, type S2R. Thin walled hollow parts are marked using mandrel support type S1R.

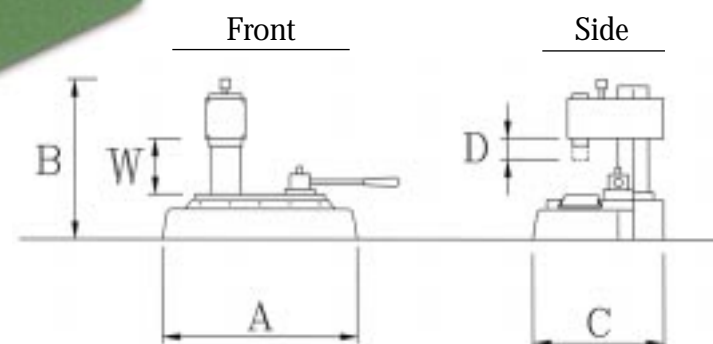

MODEL MB 41E

- Motorized version of the machine MB41N.
- With geared motor connected to 380V, 3 phase, 50 Hz.
- Mounted on bench, model TP.
- Twin push button safety system is integrated in the bench.
- Suitable for marking round components from 8-65 mm diameter.

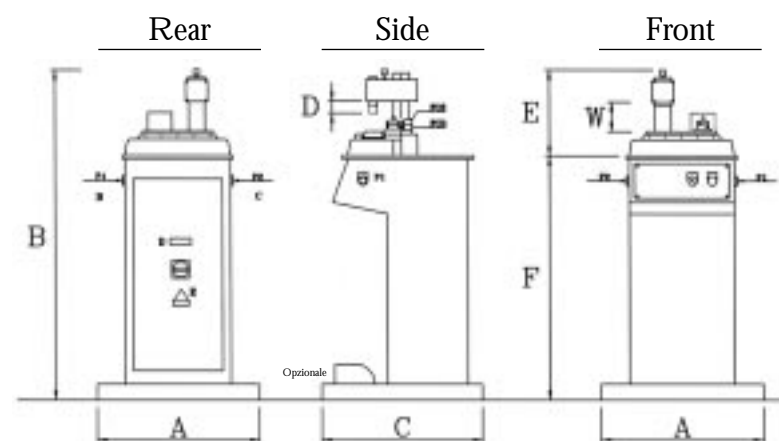

MEDIUM SIZED DIAMETERS



MODEL MB 71N

- Manually operated machine for marking, graduating numbering etc. of cylindrical, conical or flat components. Maximum diameter of round components: 110 mm
- Simple setting of depth of mark.
- The table is fitted with spring washers to even out differences in diameter and to achieve consistent depth of mark.
- Large range of accessories available.

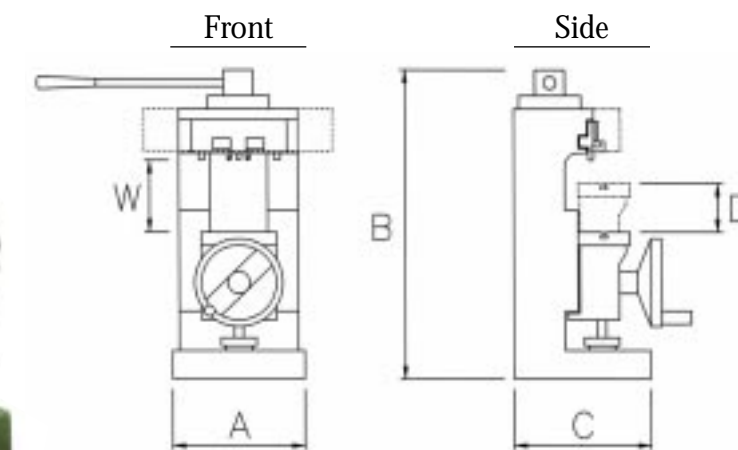

MODEL MB 71UE

- Electrical marking unit with slide movement via a geared motor.
- For marking, graduating, numbering of cylindrical, conical and flat components.
- Linear marking takes place by rolling
- Specially designed for integration in production lines.

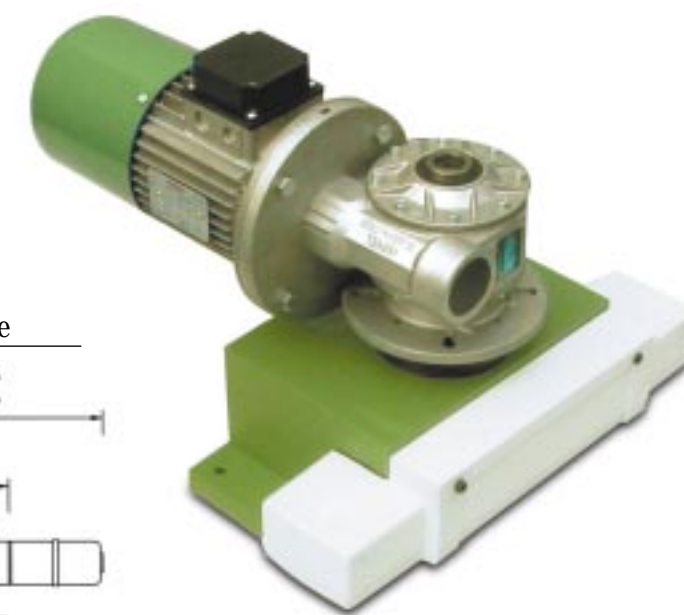
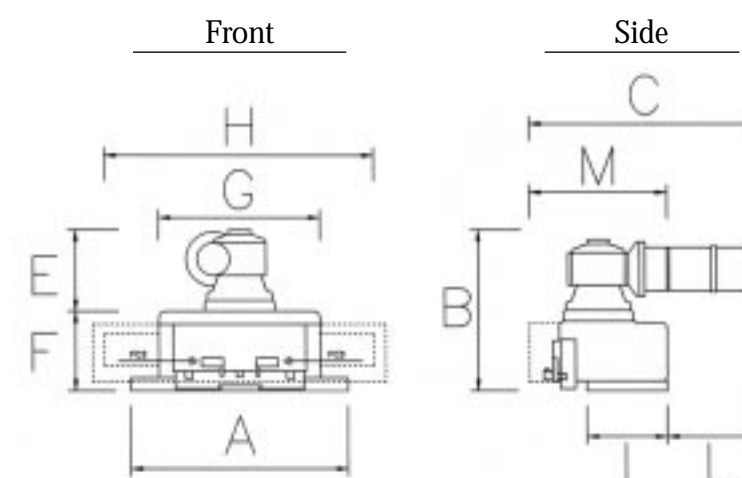

MEDIUM SIZED DIAMETERS

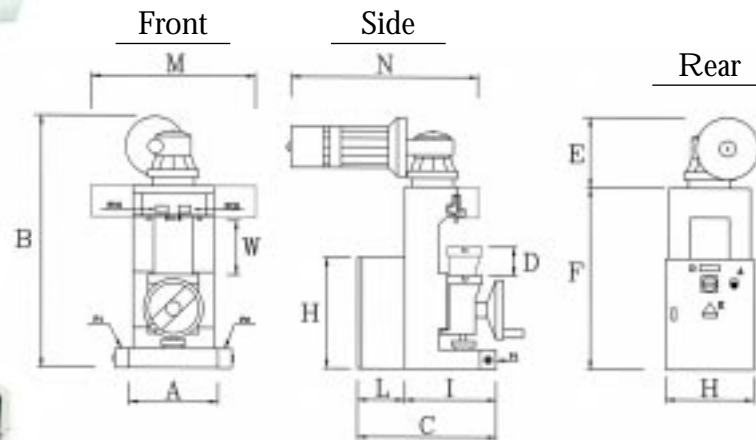

- MODEL MB 71E**
- Electrically operated roller marking machine for marking, graduating, numbering of variously shaped round components up to a maximum of 110 mm diameter.
 - Simple setting of the depth of mark.
 - The table is fitted with spring washers to even out differences in diameter and to achieve consistent depth of mark.
 - Operation is via electrical twin push buttons. All electrical components are built into the bench, type TG.

MODEL MB 71EP

- Electrically operated machine with additional pneumatic movement of the table. This ensures perfect and uniform marking every time.
- PLC control of all movements.

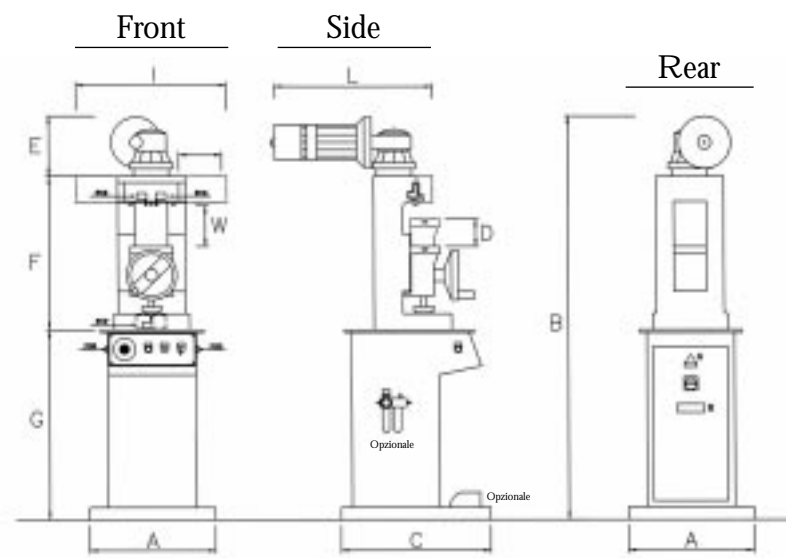

MODEL MB 71CE

Continuous, repeated marking on bars, hexagonals, tubes and profiled material etc. The symbols, logos or text are rolled into the material using a marking roller of 60 mm diameter.

Production rate: 6 metre/min.
Output can be doubled by using two rollers simultaneously.



CONTINUOUS ROLLER MARKING

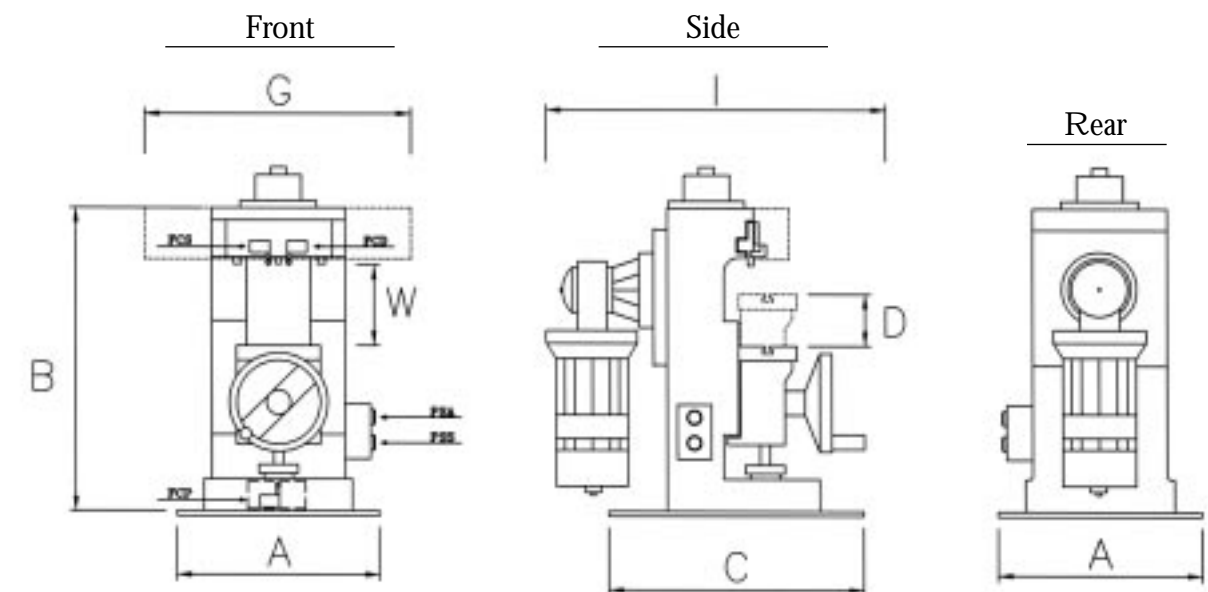



HORIZONTAL

MODEL MB 76E90° e MB 76EP90°

- These roller marking machines will mark horizontally placed round parts and flanges up to 650 mm diameter.
- The maximum length of text must not exceed 180 mm, but can be one or more lines.
- Deeper marking can be achieved by repeating the same marking cycle several times. The part to be marked is pressed against the typeholder using spring washers with adjustable resistance.
- Loading and unloading are carried out manually.
- The machine is operated using twin push button actuation.

- The pneumatic model (EP) has an approach stroke of 22 mm (to feed forward the part to the marking head).

- 2 versions are available:

E with the characteristics of the electric model MB 71E

EP with the characteristics of the electro-pneumatic model MB 71EP

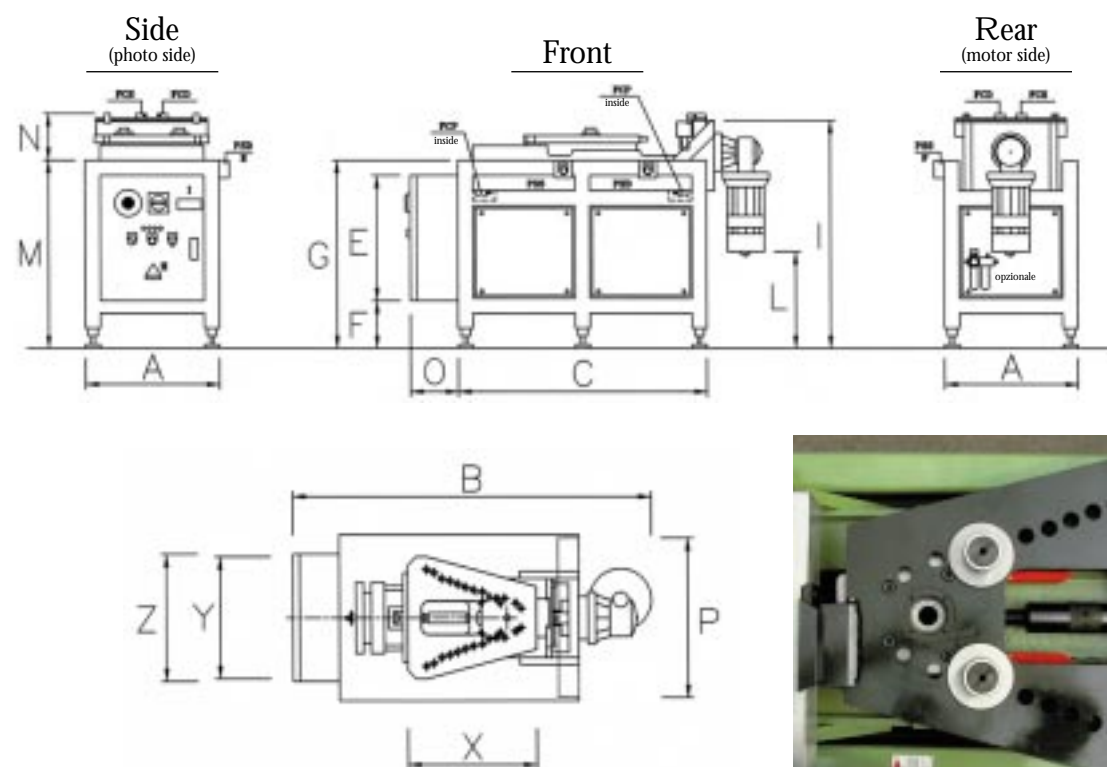

Seen from above

MODEL MB 76N, MB 76E, MB 76EP

- With these roller marking machine vertically positioned round components, rings etc up to 1000 mm diameter can be marked with any required text.
- The pneumatic model (EP) has a vertical movement of 22 mm.
- The maximum length of text is 180 mm and can be of one or more linea.
- Deeper marking can be achieved by repeating the same marking cycle several times. The part to be marked is pressed against the typeholder using spring washers.
- Loading and unloading are carried out manually.
- The machine is operated using twin push button actuation.

- 3 versions are available:

N: manual operation

E: electrically driven

EP: electrically driven with pneumatic feed of the part to the marking head

SPECIAL ROUND COMPONENTS

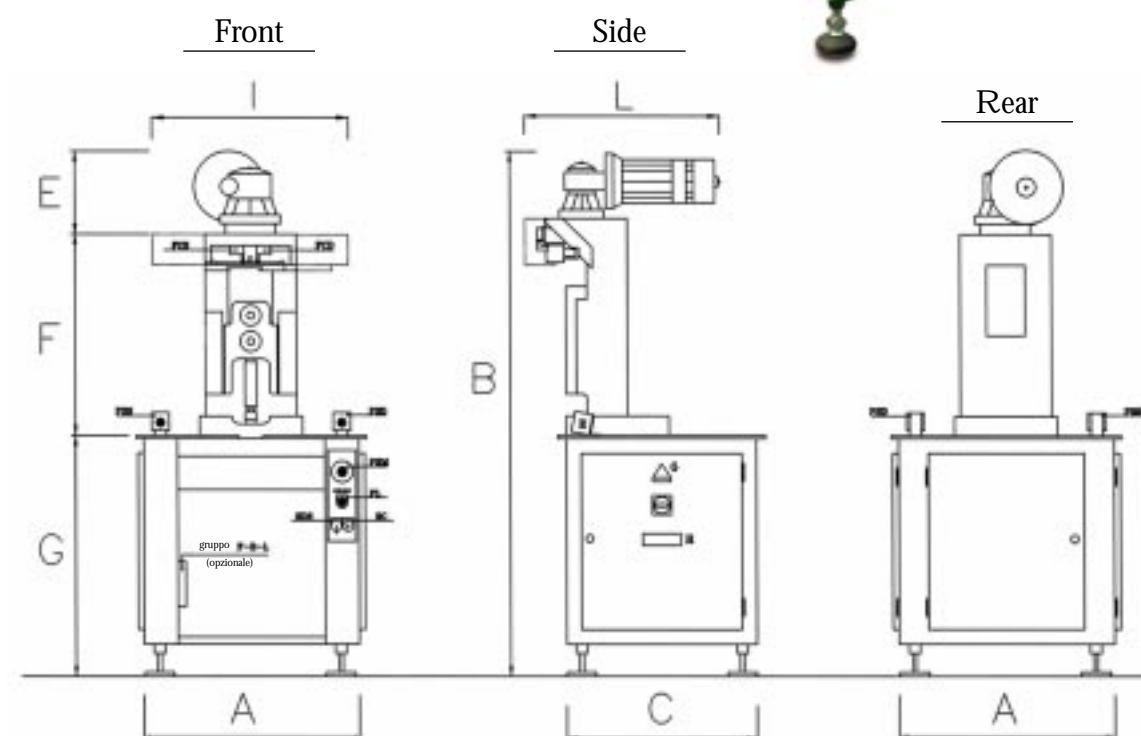

MODEL	DIMENSIONS													TECHNICAL DATA													
	A	B	C	D	E	F	G	H	I	L	M	N	O	P	X	Y	Z	W	Max. Dia. (mm)	Weight (kg)	Cap Between Columns (mm)	Motor Rating		“T” Nuts (mm)	Stroke of slide	Air Pressure (bar)	
																						(kw)	(V)				
MB 41N	295	300	240	30	—	—	—	—	—	—	—	—	—	—	—	—	—	—	125	65	35	—	—	—	100	—	
MB 41E	600	1.090	600	30	300	760	—	—	—	—	—	—	—	—	—	—	—	—	125	65	110	—	0.18	380	100	—	
MB 71N	340	830	310	125	—	—	—	—	—	—	—	—	—	—	—	—	—	—	235	110	126	130	—	—	10	180	—
MB 71E	360	1.020	500	125	230	730	350	450	310	190	480	560	—	—	—	—	—	—	235	110	138	130	0.55	380	10	180	—
MB 71EP	600	1.730	600	125	230	730	760	—	480	560	—	—	—	—	—	—	—	—	235	110	230	130	0.55	380	10	180	6-8
MB 71CE	340	830	310	125	—	—	480	—	570	—	—	—	—	—	—	—	—	—	235	80	155	130	0.55	380	10	—	—
MB 71UE	400	450	560	—	290	160	295	425	130	250	215	—	—	—	—	—	—	—	—	—	50	—	0.55	380	—	180	—
MB 76E 90°	530	1.170	1.000	—	500	190	750	—	910	380	750	190	190	480	470	350	440	—	600/650	360	—	0.55	380	—	290	—	
MB 76EP 90°	530	1.170	1.000	—	500	190	750	—	910	380	750	190	190	480	470	350	440	—	600/650	360	—	0.55	380	—	290	6-8	
MB 76E	730	1.785	650	—	280	685	820	—	480	560	—	—	—	—	—	—	—	—	1000	300	130	0.55	380	—	180	—	
MB 76EP	730	1.785	650	—	280	685	820	—	480	560	—	—	—	—	—	—	—	—	1000	300	130	0.55	380	—	180	6-8	

We reserve the right to amend specifications without notice.

SPECIAL APPLICATIONS



MARKING OF FIRE EXTINGUISHER BODIES
The sheet metal, after it has been rolled and welded is marked with the following information:
• Supplier's name
• Supplier's code
• Full capacity
• Date of manufacture
• Sequential serial number
All this information is marked in one operation using a MB76EP fitted with a special numbering head with typeholder attached.
Marking time is less than 3 seconds.

High pressure valve body marked on a MB 71EP



MARKING OF SAFETY VALVES AND FLANGES
All valves have to be marked with their own specific details: date, pressure, volume, manufacturer etc.
Certification regulations require that the valve bodies must be marked with unalterable data.

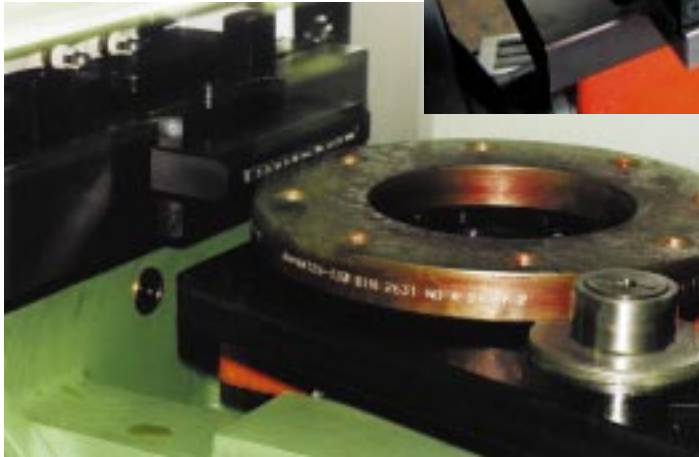

Flange marked on a MB 76EP90°

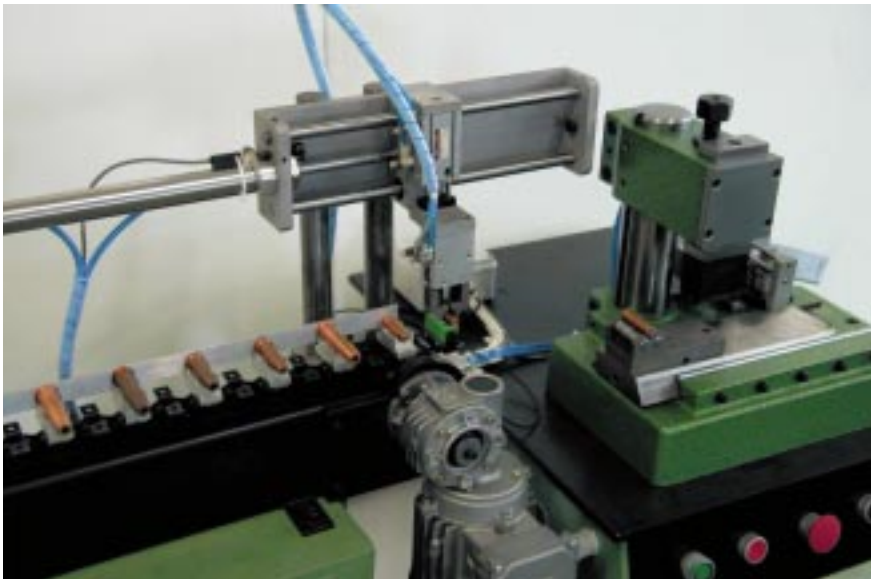

SPECIAL APPLICATION USING A ROLLER MARKER
Roller marking of motor plugs for diesel motors with automatic loading and unloading. Special tooling with component fixturing.

Roller marker, MB41E combined with automatic feeding system

ROLLER SUPPORTS

Support S2R and S2R mini

The twin roller supports S2R and S2R mini are used on roller marking machines to rotate the part to be marked. The marking head causes the part to be rotated during the marking process.

The supports designed by Automator International are intended to help the operator ensure that the force is always equally applied and that a perfect mark is produced every time. This is due to the accuracy with which every item is designed and tested.

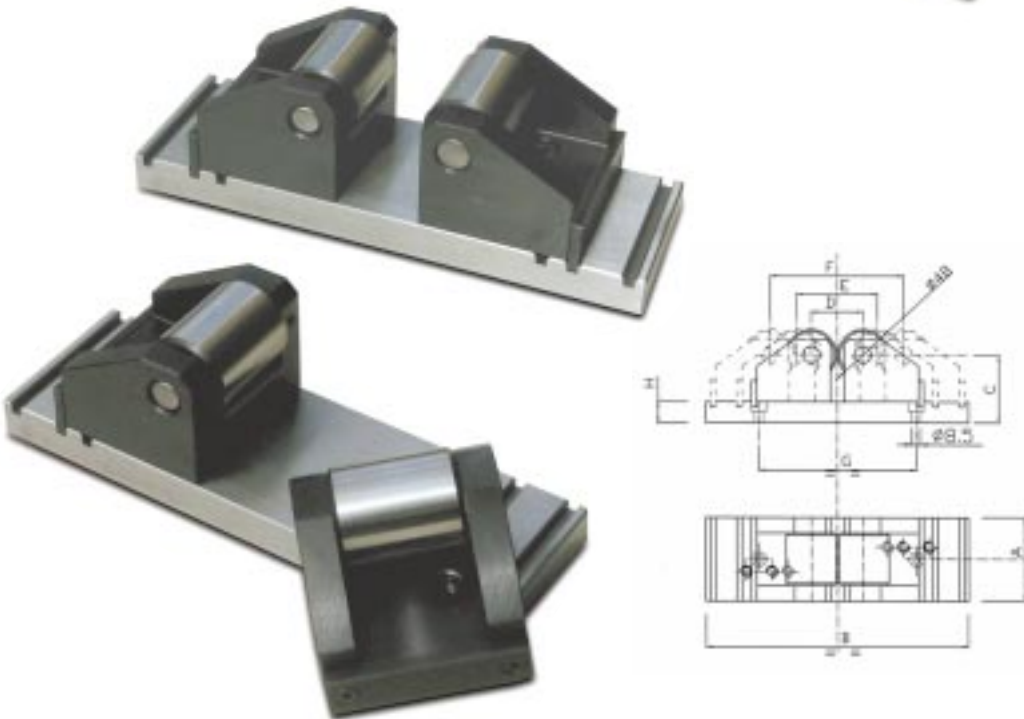

Support S2R - adjustable
With support S2R-adjustable, it is possible to set the two rollers to suit the exact diameter of the parts to be marked.

Mandrel Support S1R and S1R mini.

The manrel supports S1R and S1R mini have been designed specifically for marking thin walled tubular components.

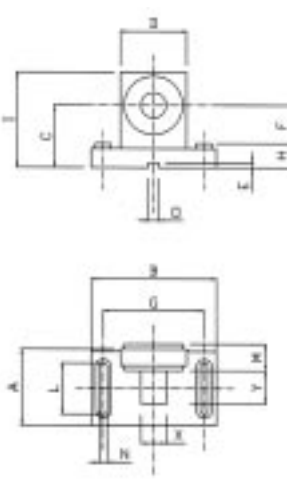

TECHNICAL DATA

Type of support	Machine model	A	B	C	D	E	F	G	H	I	L	M	N	O	X and Y	Ø Rollers
S1R	MB 41N - 41E MB 71N - 71E - 71EP MB 71UE	89	175	74	75	/	48	135	26	109	62	52	8	/	on request	/
S1R Mini	MB 41N - 41E MB 71N - 71E - 71EP MB 71UE	60	98	51	52	4	23	80	18	74	40	30	6	8	on request	/
S2R	MB 41N - 41E MB 71N - 71E - 71EP MB 71UE	80	170	48	42,5	/	44	140	19	64	65	50	13	/	/	39
S2R Mini	MB 41N - 41E MB 71N - 71E - 71EP MB 71UE	60	100	25	20,2	4	22	80	10	32	40	40	6,5	8	/	19
S2R Adjustable	MB 71N - 71E - 71EP MB 71UE	80	250	65	40	59	119	139	20	/	/	/	/	/	/	48
S3R	MB 71CE	110	170	42	49	/	40	150	20	60	15	70	10	/	/	42
SR100	MB 71N - 71E - 71EP MB 71UE	58	73	92	97	67	43	/	/	83	/	/	/	/	/	/

Roller support SR100

This roller support serves to take the circular typeholder, type RPC 101 (see page 7). It is also possible to fit 60 mm diameter dies engraved with special logos or text.

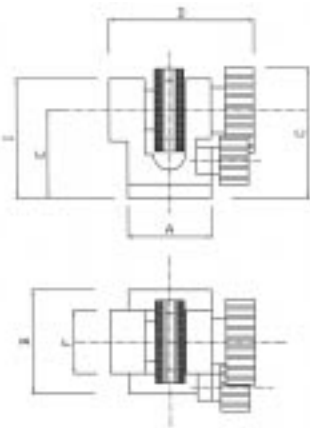

Roller support S3R

This roller support is only used on the roller marking machine, model MB71CE, and guides the bar through the machine for coninuous marking. The centre roller can be engraved to allow marking on two faces simultaneously.

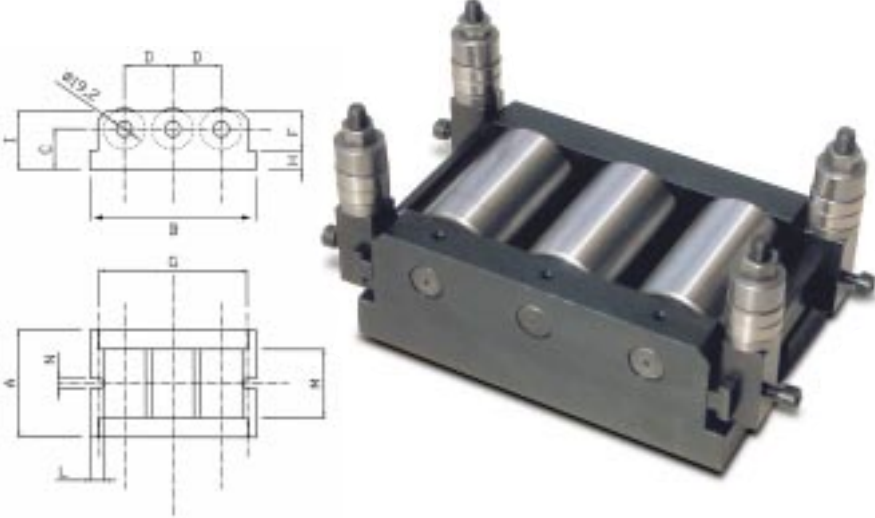

ACCESSORIES

FONT SETS



Automator steel types are of exceptional quality, incorporating as they do 50 years' experience. They are made from specially selected steel, which guarantees a long life time. The most modern production methods ensures perfect centering and exact dimensional tolerances. Standard font sets with or without a typeholder contain:

- 100 characters
- 20 blanks
- Tweezers and allen key

A A A a

Types of characters:

- standard sharp face
- multi-dot
- rounded
- flat face
- hot marking
- lower case

Height of standard character sizes

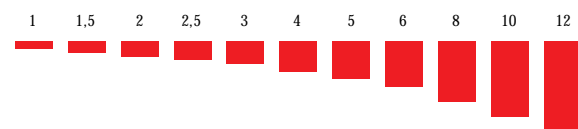

ENGRAVED STAMPS & DIES

Special dies and punches to any shape with perfect representation of logos or script are made to customers' requirements from special stel. Many years of experience guarantees highest quality and closest tolerances.



Height of standard character sizes

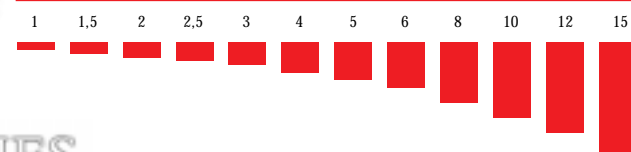

BANCHES



Model T:
Adjustable table
height from
700-790 mm.
Adjustable foot-rest
suitable for
MB15/19/20/
21/32/40N

Model TG
Compact frame
with either
laminated plastic
or steel top plate
500x600 mm
suitable for
MB32/35/
71N/71E/71CE

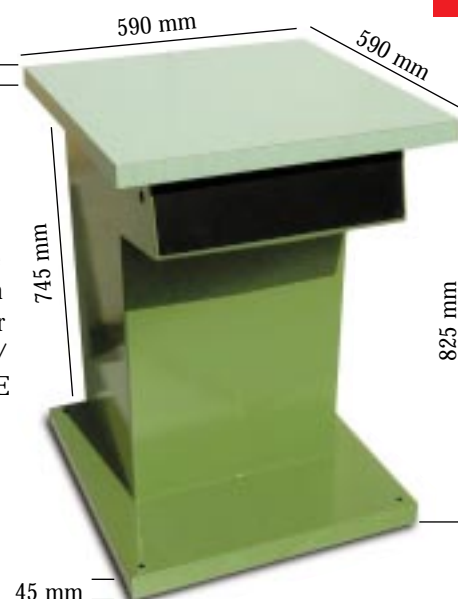

TYPEHOLDERS

An enormous range of typeholders of both standard and special design is available to resolve any marking application. The linear 1, 2 and 3 line typeholders as well as the circular typeholders all are provided with tapped hole at the rear to take the required adaptor. Because of this feature Automator typeholders can be mounted on any model of impact press or roller marking machine.



ADAPTOR PLATES

These serve to attach the typeholder to the various roller marking machines.

NUMBERING HEADS

These are ideal for marking of frequently changing numbers or sequentially incrementing serial numbers; a numbering head can be supplied for every character size and shape of component. Special numbering heads with spacer wheels, slots for holding interchangeable steel types etc. can be supplied on request. Available as two models:

- MB2 automatic
- MB14 manual



Height of standard character sizes

