

Electrak LA1-S



- IP65
- 12, 24 or 36 Vdc power supply
- Stroke from 25 to 150 mm
- End of stroke limit switches
- Self locking acme screw

Electrak LA1-SP



- IP65
- 12, 24 or 36 Vdc power supply
- Stroke from 50 to 150 mm
- Potentiometer feedback (no limit switches)
- Self locking acme screw and anti rotation mechanism

Electrak LA10

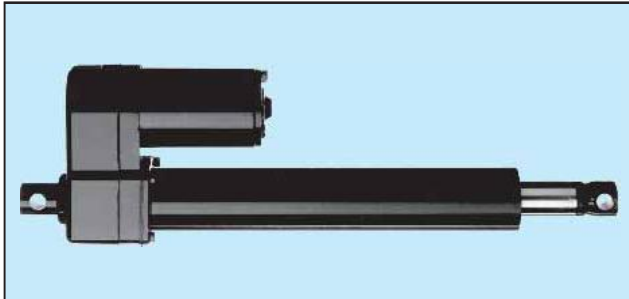

- IP65
- 12, 24 or 36 Vdc power supply
- Standard stroke up to 600 mm
- Ball or acme screw
- Custom RAL color possible.

Electrak LA14



- IP65
- 12, 24 or 36 Vdc power supply
- Standard stroke up to 600 mm
- Ball or acme screw
- Anti rotation mechanism
- Aluminium cover tube with T-slot.

Electrak LA5



- IP45
- 1 × 230 Vac or 3 × 400 Vac power supply
- Standard stroke up to 600 mm
- Ball or acme screw
- Custom RAL color possible.

Electrak LA24



- IP45
- 1 × 230 Vac or 3 × 400 Vac power supply
- Standard stroke up to 600 mm
- Ball or acme screw
- Anti rotation mechanism
- Aluminium cover tube with T-slot
- Version without motor available (ElectrakFA14).

Technical data



Available input voltages [Vdc]	12, 24 or 36
Available screw types	Acme
Max. static load at fully retracted [N]	1300
Min. / max. standard stroke [inch]	
S-model	1 / 6
SP-model	2 / 6
Duty cycle @ 25° C [%]	25
Temperature limits at operation [°C]	- 25 to + 65
Protection degree	IP65
Max. end play [mm]	0,9
Restraining torque [Nm]	
S-model	2,3
SP-model	-
Wire cross section [mm ²]	1
Wire length [mm]	100
Connector included	yes

Features for both LA1-S and LA1-SP

- Small
- Weather resistant (IP65)
- Withstand 96 hour salt spray test
- Motor with auto reset thermal overload protection
- Self locking acme screw
- Can operate in a large temperature range
- Accepts large input voltage variations
- Maintenance free
- Models with higher load capacity possible on demand

Features for LA1-S

- End of stroke limit switches
- Six standard strokes

Features for LA1-SP

- Potentiometer feedback
- Anti rotation mechanism
- Three standard strokes

Options

- Custom RAL color

Engineering notes

- No clutch

Performance table

Model	Max. dynamic load [N]	Speed @ min. load [mm/s]	Speed @ max. load [mm/s]
S(P)12-09A04	110	75	52
S(P)24-09A04	110	75	52
S(P)12-09A08	225	45	33
S(P)24-09A08	225	45	33
S(P)12-17A08	340	26	17
S(P)24-17A08	340	26	17
S(P)12-17A16	340	14	7
S(P)24-17A16	340	14	7

Standard strokes

LA1-S ordering stroke	Actual stroke S [mm]
01	21
02	46
03	72
04	97
05	122
06	148

LA1-SP ordering stroke	Actual stroke S [mm]
02	59
04	115
06	171

Technical data



Available input voltages [Vdc]	12, 24 or 36
Available screw types	Acme or Ball
Max. static load at fully retracted [N]	
Acme screw models	11 350
Ball screw models	18 000
Min. / max. standard stroke [inch]	4 / 24
Duty cycle @ 25° C [%]	25
Temperature limits at operation [°C]	- 25 to + 65
Protection degree	IP65
Max. end play [mm]	1
Restraining torque [Nm]	11,3
Wire cross section [mm ²]	2
Wire length [mm]	165
Connector included	yes

Features

- Rugged and robust
- Weather resistant (IP65)
- Withstand 96 hour salt spray test
- Overload clutch (set to 1,2 – 1,5 × max. permissible load)
- Motor with auto reset thermal overload protection
- Acme or ball screw drive
- Holding brake prevents back driving on ball screw models
- Acme screw models are self-locking
- Safety nut on all ball screw models
- Can operate in a large temperature range
- Accepts large input voltage variations
- Maintenance free

Options

- Potentiometer feedback
- Hand wind
- Custom RAL color

Performance table

Model	Max. dynamic load [N]	Speed @ min. load [mm/s]	Speed @ max. load [mm/s]
D12-05A5	1100	54	32
D24-05A5	1100	54	32
D12-05B5	2250	61	37
D24-05B5	2250	61	37
D12-10A5	2250	30	18
D24-10A5	2250	30	18
D12-10B5	4500	30	19
D24-10B5	4500	30	19
D12-20A5	2250	15	12
D24-20A5	2250	15	12
D12-20B5	4500	15	12
D24-20B5	4500	15	12
D12-21B5	6800	15	11
D24-21B5	6800	15	11

Standard strokes

Ordering stroke [inch]	Actual stroke S [mm]
4	102
6	152
8	203
10	254
12	305
14	356
16	406
18	457
20	508
24	610

Dimensions

Acme screw driven models

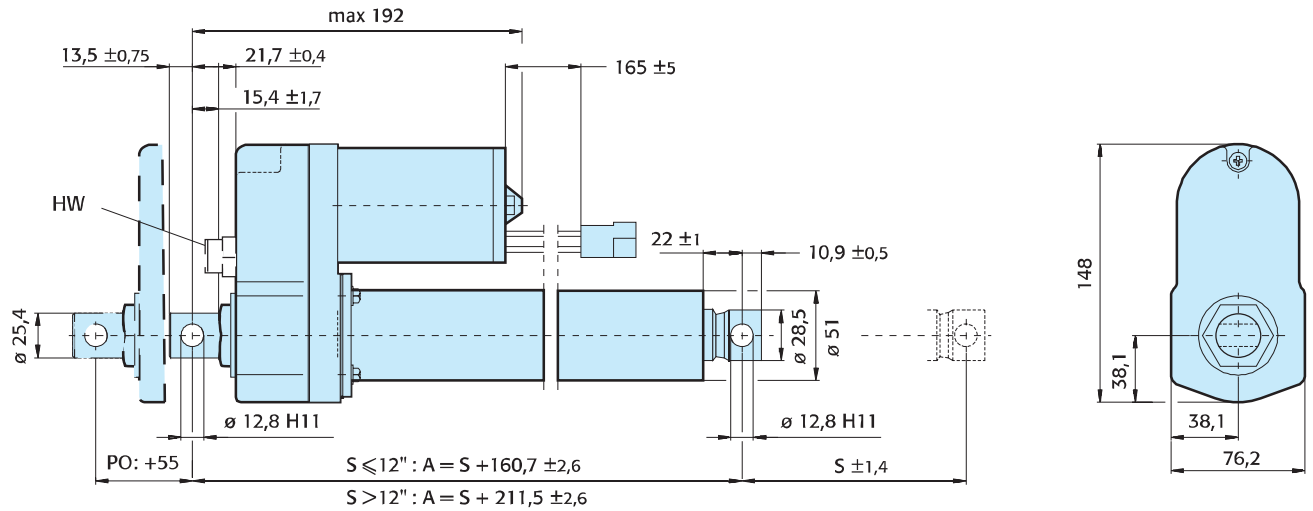

Ball screw driven models

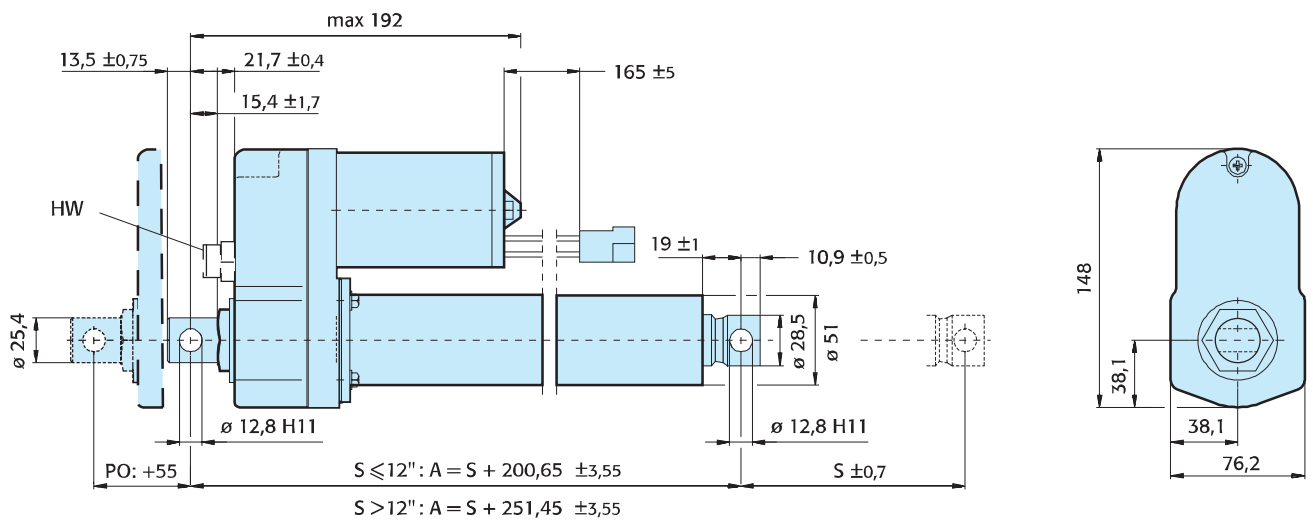

Performance diagrams

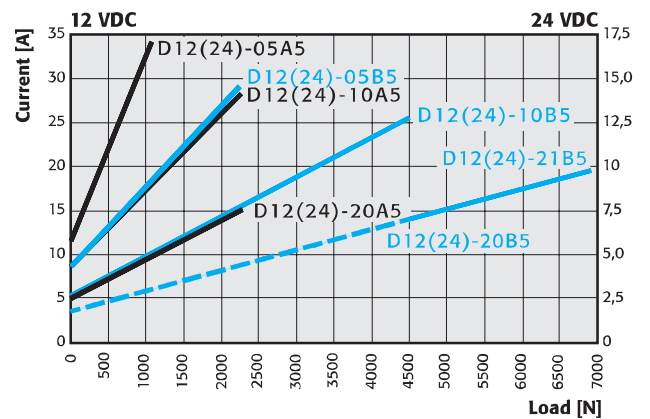
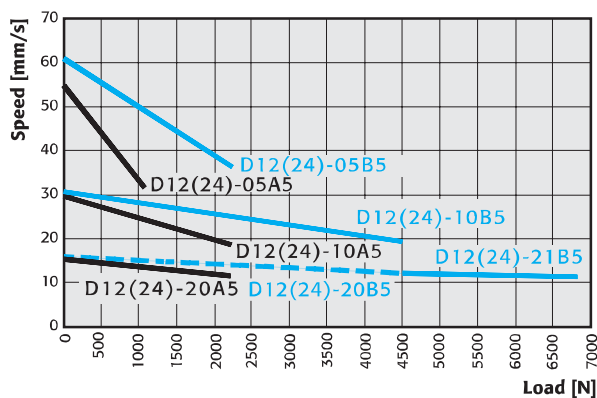

Technical data

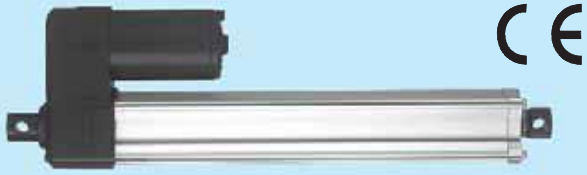
	
Available input voltages [Vdc]	12, 24 or 36
Available screw types	Acme or Ball
Max. static load at fully retracted [N]	
Acme screw models	11 350
Ball screw models	18 000
Min. / max. standard stroke [mm]	50 / 600
Duty cycle @ 25° C [%]	25
Temperature limits at operation [°C]	- 25 to + 65
Protection degree	IP65
Max. end play [mm]	1
Restraining torque [Nm]	–
Wire cross section [mm ²]	2
Wire length [mm]	165
Connector included	yes

Features

- Rugged and robust
- Aluminium cover tube with T-slot
- Position sensors can be fitted to the T-slots
- Trunnion mounting possible
- Anti rotation mechanism
- Weather resistant (IP65)
- Overload clutch (set to 1,2 – 1,5 × max. permissible load)
- Motor with auto reset thermal overload protection
- Acme or ball screw drive
- Holding brake prevents back driving on ball screw models
- Acme screw models are self-locking
- Safety nut on all ball screw models
- Can operate in a large temperature range
- Accepts large input voltage variations
- Maintenance free

Options

- Potentiometer feedback
- Hand wind
- Custom RAL color

Performance table

Model	Max. dynamic load [N]	Speed @ min. load [mm/s]	Speed @ max. load [mm/s]
DA12–05A5	1100	54	32
DA24–05A5	1100	54	32
DA12–05B5	2250	61	37
DA24–05B5	2250	61	37
DA12–10A5	2250	30	18
DA24–10A5	2250	30	18
DA12–10B5	4500	30	19
DA24–10B5	4500	30	19
DA12–20A5	2250	15	12
DA24–20A5	2250	15	12
DA12–20B5	4500	15	12
DA24–20B5	4500	15	12
DA12–21B5	6800	15	11
DA24–21B5	6800	15	11

Standard strokes

Ordering stroke [cm]	Actual stroke S [mm]
5	50
10	100
15	150
20	200
25	250
30	300
35	350
40	400
45	450
50	500
55	550
60	600

Dimensions

Acme screw driven models

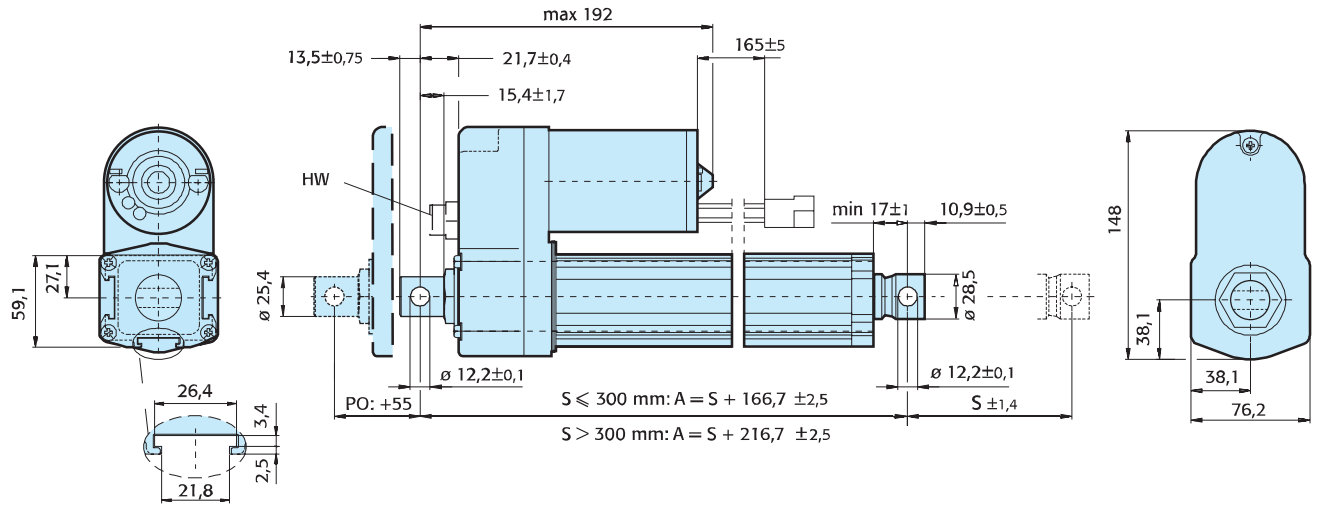

Ball screw driven models

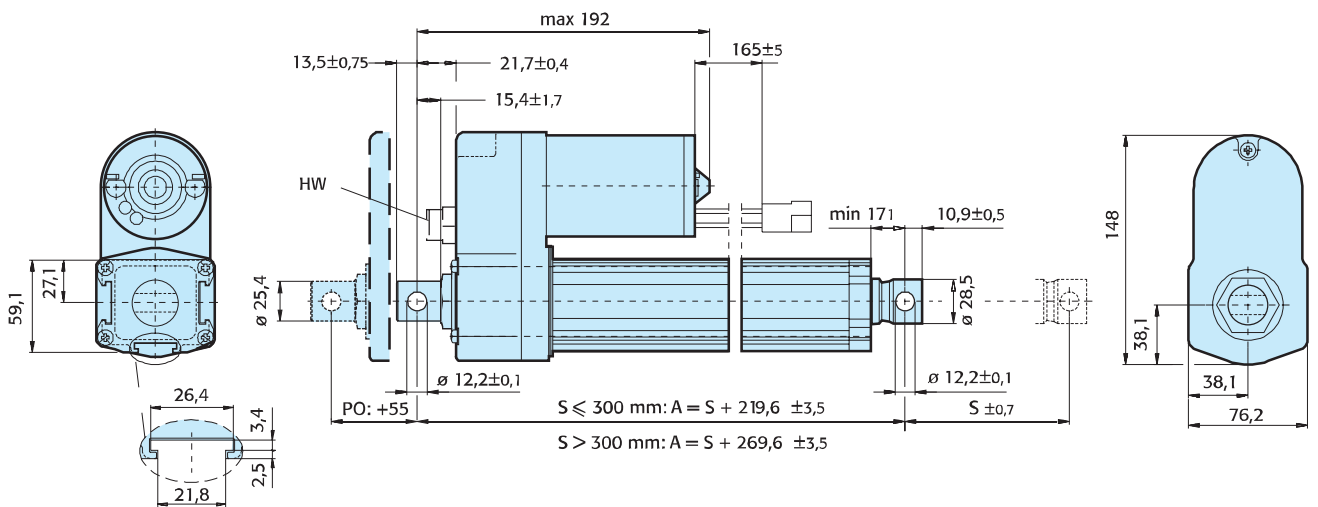

Performance diagrams

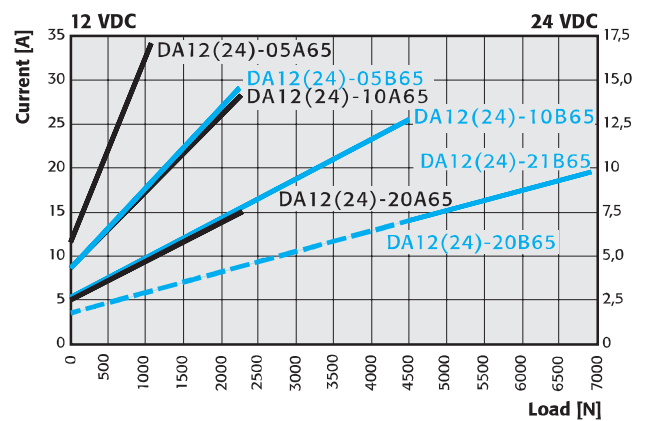
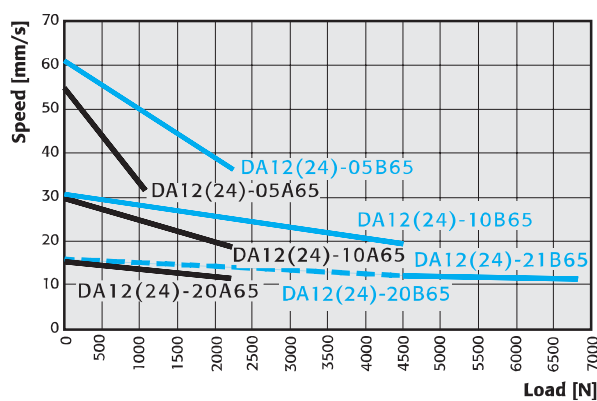

Technical data



Available input voltages [Vac]	1 × 230 or 3 × 400
Input frequency [Hz]	50
Available screw types	Acme or Ball
Max. static load at fully retracted [N]	
Acme screw models	11 350
Ball screw models	18 000
Min. / max. standard stroke [inch]	4 / 24
Duty cycle @ 25° C [%]	25
Max. operation time [s]	45
Temperature limits at operation [°C]	- 25 to + 65
Protection degree	IP45
Max. end play [mm]	1
Restraining torque [Nm]	12
Wire cross section [mm ²]	1,5
Wire length [mm]	600
Connector included	no

Features

- Rugged and robust
- Overload clutch (set to 1,2 – 1,5 × max. permissible load)
- Motor with auto reset thermal overload protection
- Acme or ball screw drive
- Holding brake prevents back driving on ball screw models
- Acme screw models are self-locking
- Anti coast brake on all ball screw models (optional on acme models)
- Safety nut on all ball screw models
- Can operate in a large temperature range
- Accepts large input voltage variations
- Maintenance free

Options

- Potentiometer feedback
- Hand wind
- Custom RAL color

Engineering notes

- Capacitor (10 µF) necessary on 230 Vac models, p/no. D9200-448-003

Performance table

Model	Max. dynamic load [N]	Speed @ min. load [mm/s]	Speed @ max. load [mm/s]
A22-05A5	1100	48	38
A22-05B5	2250	61	37
A42-05B5	2250	61	37
A22-10A5	2250	30	18
A42-10A5	2250	30	18
A22-10B5	4500	30	19
A42-10B5	4500	30	19
A22-20A5	2250	15	12
A42-20A5	2250	15	12
A22-20B5	4500	15	12
A42-20B5	4500	15	12
A22-21B5	6800	15	11
A42-21B5	6800	15	11

Standard strokes

Ordering stroke [inch]	Actual stroke S [mm]
4	102
6	152
8	203
10	254
12	305
14	356
16	406
18	457
20	508
24	610

Dimensions

Acme screw driven models

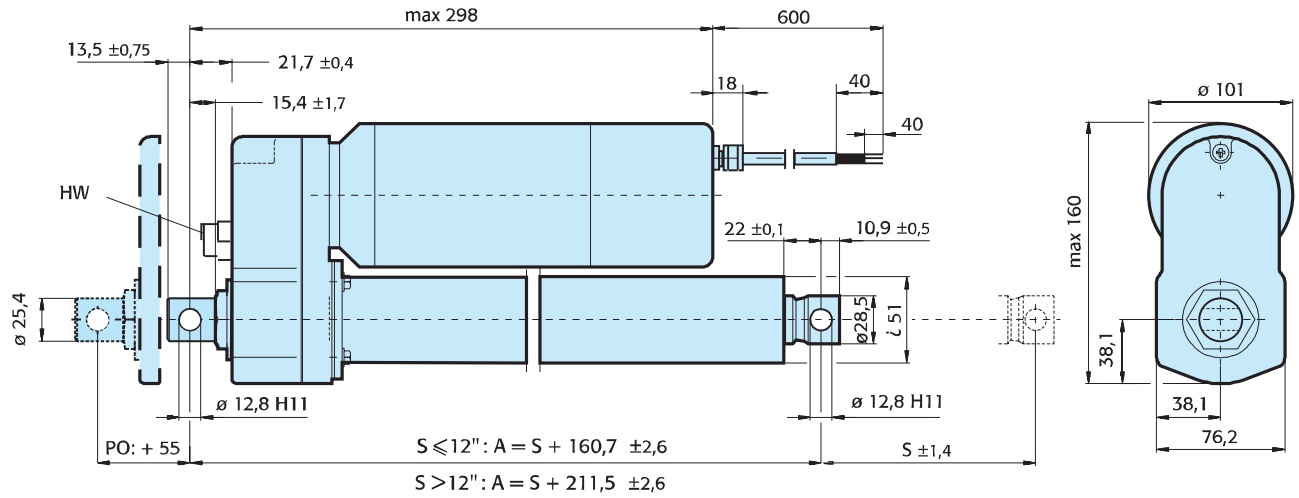

Ball screw driven models

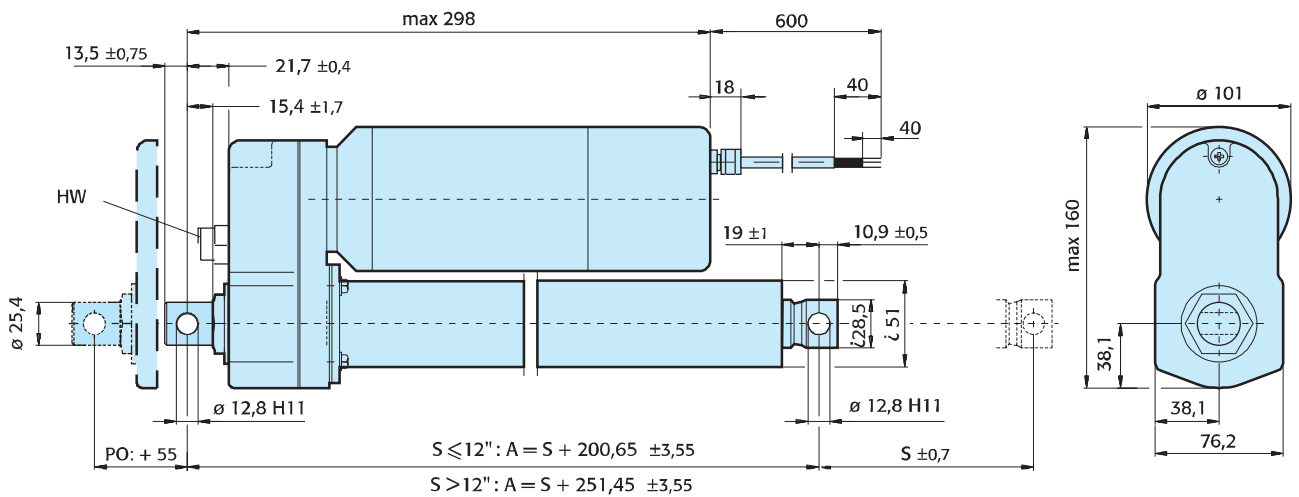

Performance diagrams

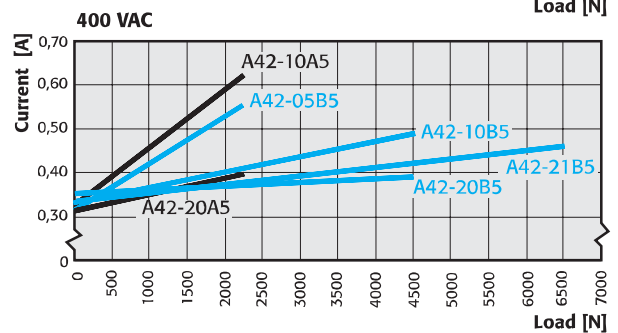
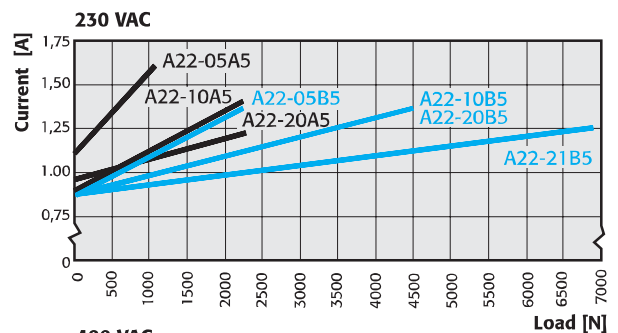
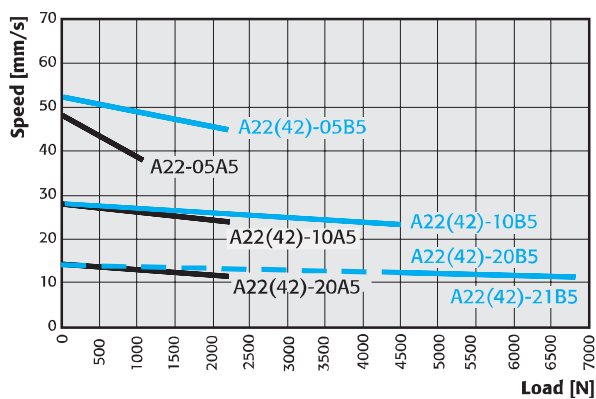

Technical data

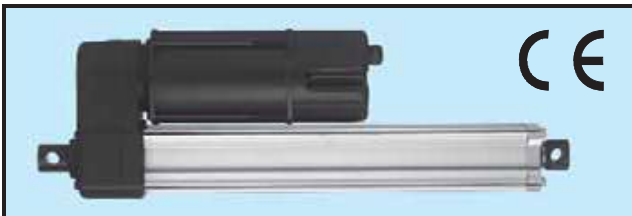

Available input voltages [Vac]	1 × 230 or 3 × 400
Input frequency [Hz]	50
Available screw types	Acme or Ball
Max. static load at fully retracted [N]	
Acme screw models	11 350
Ball screw models	18 000
Min. / max. standard stroke [mm]	50 / 600
Duty cycle @ 25° C [%]	25
Max. operation time [s]	45
Temperature limits at operation [°C]	- 25 to + 65
Protection degree	IP45
Max. end play [mm]	1
Restraining torque [Nm]	–
Wire cross section [mm ²]	1,5
Wire length [mm]	600
Connector included	no

Features

- Rugged and robust
- Aluminium cover tube with T-slot
- Position sensors can be fitted to the T-slots
- Trunnion mounting possible
- Anti rotation mechanism
- Withstand 96 hour salt spray test
- Overload clutch (set to 1,2 – 1,5 × max. permissible load)
- Motor with auto reset thermal overload protection
- Acme or ball screw drive
- Holding brake prevents back driving on ball screw models
- Acme screw models are self-locking
- Safety nut on all ball screw models
- Can operate in a large temperature range
- Accepts large input voltage variations
- Maintenance free

Options

- Potentiometer feedback
- Hand wind
- Custom RAL color

Engineering notes

- Capacitor (10 µF) necessary on 230 Vac models

Performance table

Model	Max. dynamic load [N]	Speed @ min. load [mm/s]	Speed @ max. load [mm/s]
AA22-05A65	1100	48	38
AA22-05B65	2250	52	45
AA42-05B65	2250	52	45
AA22-10A65	2250	28	24
AA42-10A65	2250	28	24
AA22-10B65	4500	28	24
AA42-10B65	4500	28	24
AA22-20A65	2250	14	11
AA42-20A65	2250	14	11
AA22-20B65	4500	14	11
AA42-20B65	4500	14	11
AA22-21B65	6800	12	11
AA42-21B65	6800	12	11

Standard strokes

Ordering stroke [cm]	Actual stroke S [mm]
5	50
10	100
15	150
20	200
25	250
30	300
35	350
40	400
45	450
50	500
55	550
60	600

Electrak FA14 (no motor)

Technical data

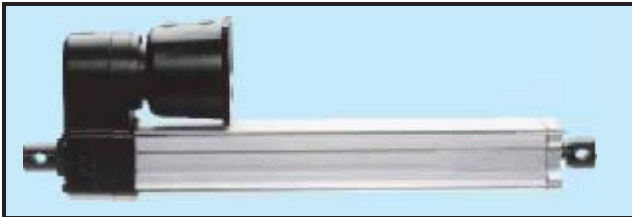

Available screw types	Acme or Ball
Max. static load at fully retracted [N]	
Acme screw models	11 350
Ball screw models	18 000
Min. / max. standard stroke [mm]	100 / 600
Max. input speed [rpm]	3000
Max. input torque [Nm]	1,8
Max. end play [mm]	1
Restraining torque [Nm]	–

Features

- Rugged and robust
- Motor fitted by customer
- Aluminium cover tube with T-slot
- Position sensors can be fitted to the T-slots
- Trunnion mounting possible
- Anti rotation mechanism
- Overload clutch (set to 1,2 – 1,5 × max. permissible load)
- Acme or ball screw drive
- Holding brake prevents back driving on ball screw models
- Acme screw models are self-locking
- Safety nut on all ball screw models
- Maintenance free

Options

- Hand wind
- Custom RAL color

Performance table

Model	Max. dynamic load [N]	Speed @ max. load [mm/s]*
FA14-05A65	1100	32
FA14-05B65	2250	37
FA14-10A65	2250	18
FA14-0B65	4500	19
FA14-20A65	2250	12
FA14-20B65	4500	12
FA14-21B65	6800	11

*Recommended value

Standard strokes

Ordering stroke [cm]	Actual stroke S [mm]
5	50
10	100
15	150
20	200
25	250
30	300
35	350
40	400
45	450
50	500
55	550
60	600

Dimensions

Acme screw driven models

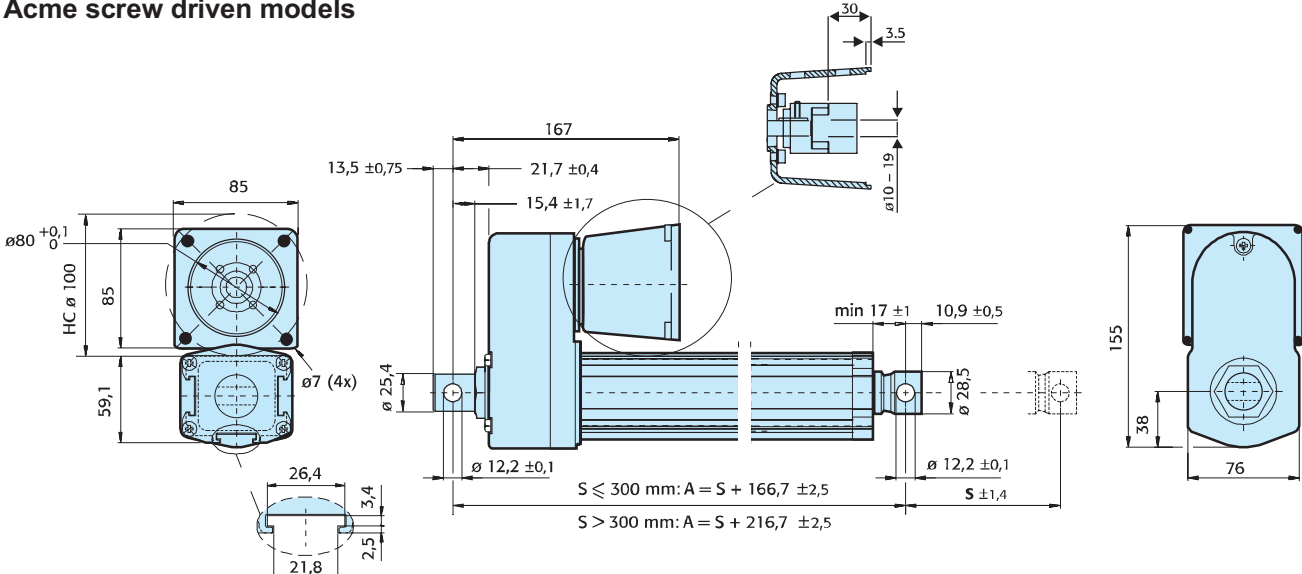

Ball screw driven models

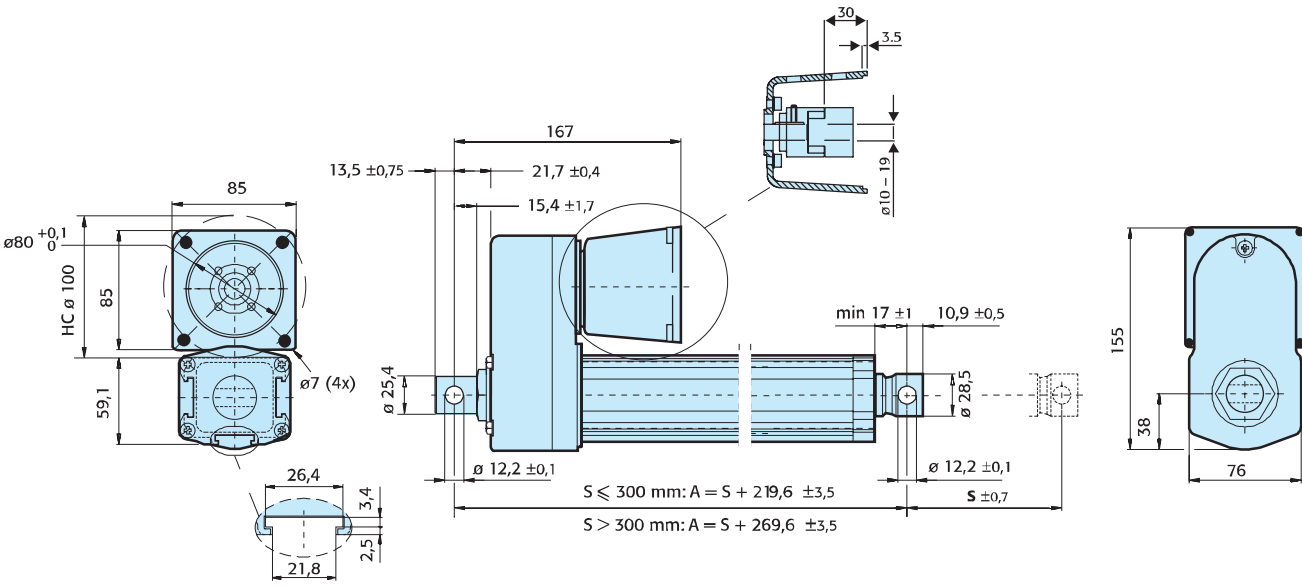

Electrak LA1-S

Designation example	S	12	-	09A04	-	02
Actuator type LA1-S (with end of stroke limit switches)	S					
Supply voltage 12 Vdc 24 Vdc 36 Vdc		12 24 36				
Hyphen			-			
Gear ratio / screw type / screw lead 9:1 / acme screw / 6,35 mm 9:1 / acme screw / 3,18 mm 17:1 / acme screw / 3,18 mm 17:1 / acme screw / 1,59 mm				09A04 09A08 17A08 17A16		
Hyphen					-	
Stroke 21 mm 46 mm 72 mm 97 mm 122 mm 148 mm						01 02 03 04 05 06

Electrak LA1-SP

Designation example	SP	12	-	09A04	-	02
Actuator type LA1-SP (with feedback potentiometer)	SP					
Supply voltage 12 Vdc 24 Vdc 36 Vdc		12 24 36				
Hyphen			-			
Gear ratio / screw type / screw lead 9:1 / acme screw / 6,35 mm 9:1 / acme screw / 3,18 mm 17:1 / acme screw / 3,18 mm 17:1 / acme screw / 1,59 mm (not possible with 171,5 mm stroke)				09A04 09A08 17A08 17A16		
Hyphen					-	
Stroke 59 mm 115 mm 172 mm (not possible with gear and screw combination 17A16)						02 04 06

Electrak LA10

Designation example	D	24	-	10B5	-	06	M0	N	
Actuator type LA10	D								
Supply voltage 12 Vdc 24 Vdc 36 Vdc		12 24 36							
Hyphen			-						
Gear ratio / screw type / screw lead 5:1 / acme screw / 5,08 mm 10:1 / acme screw / 5,08 mm 20:1 / acme screw / 5,08 mm 5:1 / ball screw / 5,08 mm 10:1 / ball screw / 5,08 mm 20:1 / ball screw / 5,08 mm 20:1 / ball screw / 5,08 mm with hardened gear				05A5 10A5 20A5 05B5 10B5 20B5 21B5					
Engineering unit Inch					-				
Stroke 4 inch (102 mm) 6 inch (152 mm) 8 inch (203 mm) 10 inch (254 mm) 12 inch (305 mm) 14 inch (356 mm) 16 inch (406 mm) 18 inch (457 mm) 20 inch (508 mm) 24 inch (610 mm)						04 06 08 10 12 14 16 18 20 24			
Adaptor hole position (for definition see page 26) Rear adaptor 0° (standard position) Rear adaptor 30° Rear adaptor 60° Rear adaptor 90° Rear adaptor 120° Rear adaptor 150°							M0 M1 M2 M3 M4 M5		
Anti coast brake No anti coast brake								N	
Options No option - leave position blank Feedback potentiometer Hand wind									PO HW

Electrak LA14

Designation example	DA	24	-	20A65	M	25	MF	N	PO
Actuator type LA14	DA								
Supply voltage 12 Vdc 24 Vdc 36 Vdc		12 24 36							
Hyphen			-						
Gear ratio / screw type / screw diameter / screw lead 5:1 / acme screw / 15,88 mm / 5,08 mm 10:1 / acme screw / 15,88 mm / 5,08 mm 20:1 / acme screw / 15,88 mm / 5,08 mm 5:1 / ball screw / 15,88 mm / 5,08 mm 10:1 / ball screw / 15,88 mm / 5,08 mm 20:1 / ball screw / 15,88 mm / 5,08 mm 20:1 / ball screw / 15,88 mm / 5,08 mm with hardened gear				05A65 10A65 20A65 05B65 10B65 20B65 21B65					
Engineering unit Metric					M				
Stroke 5 cm 10 cm 15 cm 20 cm 25 cm 30 cm 35 cm 40 cm 45 cm 50 cm 55 cm 60 cm						05 10 15 20 25 30 35 40 45 50 55 60			
Adaptor hole position (for definition see page 26) Rear adaptor 0° (standard position) Rear adaptor 30° Rear adaptor 60° Rear adaptor 90° Rear adaptor 120° Rear adaptor 150° Rear and front adaptor 90°							M0 M1 M2 M3 M4 M5 MF		
Anti coast brake No anti coast brake								N	
Options No option - leave position blank Feedback potentiometer Hand wind									PO HW

Electrak LA5

Designation example	A	22	-	10B5	-	04	M0	B	HW
Actuator type LA5	A								
Supply voltage 1 × 230 Vac, 50 Hz 3 × 400 Vac, 50 Hz		22 42							
Hyphen			-						
Gear ratio / screw type / screw diameter / screw lead 5:1 / acme screw / 15,88 mm / 5,08 mm (not possible with 400 Vac motor) 10:1 / acme screw / 15,88 mm / 5,08 mm 20:1 / acme screw / 15,88 mm / 5,08 mm 5:1 / ball screw / 15,88 mm / 5,08 mm 10:1 / ball screw / 15,88 mm / 5,08 mm 20:1 / ball screw / 15,88 mm / 5,08 mm 20:1 / ball screw / 15,88 mm / 5,08 mm with hardened gear				05A5 10A5 20A5 05B5 10B5 20B5 21B5					
Engineering unit Inch					-				
Stroke 4 inch (102 mm) 6 inch (152 mm) 8 inch (203 mm) 10 inch (254 mm) 12 inch (305 mm) 14 inch (356 mm) 16 inch (406 mm) 18 inch (457 mm) 20 inch (508 mm) 24 inch (610 mm)						04 06 08 10 12 14 16 18 20 24			
Adaptor hole position (for definition see page 26) Rear adaptor 0° (standard position) Rear adaptor 30° Rear adaptor 60° Rear adaptor 90° Rear adaptor 120° Rear adaptor 150°							M0 M1 M2 M3 M4 M5		
Anti coast brake No anti coast brake Anti coast brake								N B	
Options No option - leave position blank Feedback potentiometer Hand wind									PO HW

Electrak LA24

Designation example	AA	42	-	20A65	M	30	M3	N	HW
Actuator type LA24	AA								
Supply voltage 1 × 230 Vac, 50 Hz 3 × 400 Vac, 50 Hz		22 42							
Hyphen			-						
Gear ratio / screw type / screw diameter / screw lead 5:1 / acme screw / 15,88 mm / 5,08 mm (not possible with 400 Vac motor) 10:1 / acme screw / 15,88 mm / 5,08 mm 20:1 / acme screw / 15,88 mm / 5,08 mm 5:1 / ball screw / 15,88 mm / 5,08 mm 10:1 / ball screw / 15,88 mm / 5,08 mm 20:1 / ball screw / 15,88 mm / 5,08 mm 20:1 / ball screw / 15,88 mm / 5,08 mm with hardened gear				05A65 10A65 20A65 05B65 10B65 20B65 21B65					
Engineering unit Metric					M				
Stroke 5 cm 10 cm 15 cm 20 cm 25 cm 30 cm 35 cm 40 cm 45 cm 50 cm 55 cm 60 cm						05 10 15 20 25 30 35 40 45 50 55 60			
Adaptor hole position (for definition see page 26) Rear adaptor 0° (standard position) Rear adaptor 30° Rear adaptor 60° Rear adaptor 90° Rear adaptor 120° Rear adaptor 150° Rear and front adaptor 90°							M0 M1 M2 M3 M4 M5 MF		
Anti coast brake No anti coast brake Anti coast brake								N B	
Options No option - leave position blank Feedback potentiometer Hand wind									PO HW